

410 North Marhsall Stree, Henderson, TX 75652-5930

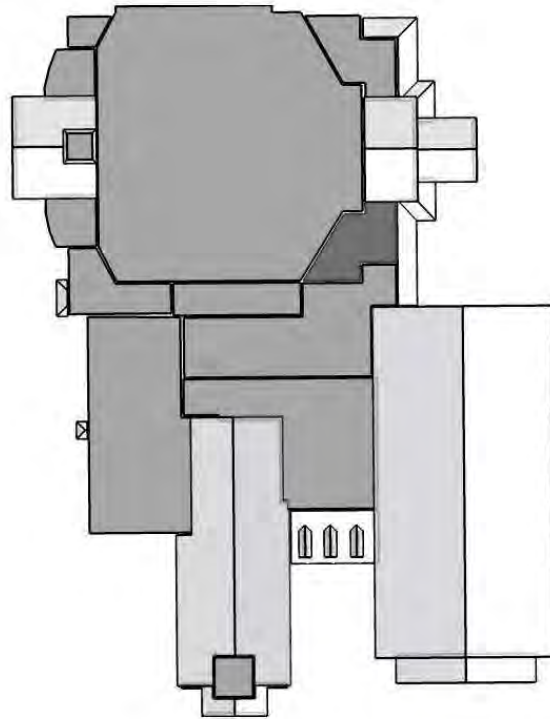

In this 3D model, facets appear as semi-transparent to reveal overhangs.

Report Details	Property Details	Property Details	Report Contents
Report:2286283	Year Built/Effective Year Built: NA/NA* <i>* This is when the property's major components were revised to meet that year's code.</i>	Total Area =49389 sq ft Total Roof Facets =57 Predominant Pitch =0/12 Total Ridges/Hips =448 ft Total Valleys =47 ft Total Rakes =469 ft Total Eaves =1,196 ft	Images.....1 Length Diagram .....4 Pitch Diagram .....5 Area Diagram.....6 Notes Diagram .....7 Report Summary .....8

Contact: Dewey Richardson  
 Company: Tri State Roofing of Texarkana  
 Address: 28 Morris Lane, Suite 133  
 Texarkana TX 75504  
 Phone: 225-936-3048

Measurements provided by [www.eagleview.com](http://www.eagleview.com)



**Certified Accurate**  
[www.eagleview.com/Guarantee.aspx](http://www.eagleview.com/Guarantee.aspx)

This document is provided under License by EagleView Technologies to the requestor for their Internal Use Only subject to the terms and conditions previously agreed to by the requestor when they registered for use of EagleView Technologies Services.

It remains the property of EagleView Technologies and may be reproduced and distributed only within the requestor's company. Any reproduction or distribution to anyone outside of the requestor's company without EagleView's prior written permission is strictly prohibited. All aspects and handling of this report are subject to the Terms and Conditions previously agreed to by the requestor.

### Images

The following aerial images show different angles of this structure for your reference.

Top View



Report: 2286283

This document is provided under License by EagleView Technologies to the requestor for their Internal Use Only subject to the terms and conditions previously agreed to by the requestor when they registered for use of EagleView Technologies Services. It remains the property of EagleView Technologies and may be reproduced and distributed only within the requestor's company. Any reproduction or distribution to anyone outside of the requestor's company without EagleView's prior written permission is strictly prohibited. All aspects and handling of this report are subject to the Terms and Conditions previously agreed to by the requestor.

North Side



South Side



Report: 2286283

This document is provided under License by EagleView Technologies to the requestor for their Internal Use Only subject to the terms and conditions previously agreed to by the requestor when they registered for use of EagleView Technologies Services. It remains the property of EagleView Technologies and may be reproduced and distributed only within the requestor's company. Any reproduction or distribution to anyone outside of the requestor's company without EagleView's prior written permission is strictly prohibited. All aspects and handling of this report are subject to the Terms and Conditions previously agreed to by the requestor.

East Side



West Side



Report: 2286283

This document is provided under License by EagleView Technologies to the requestor for their Internal Use Only subject to the terms and conditions previously agreed to by the requestor when they registered for use of EagleView Technologies Services. It remains the property of EagleView Technologies and may be reproduced and distributed only within the requestor's company. Any reproduction or distribution to anyone outside of the requestor's company without EagleView's prior written permission is strictly prohibited. All aspects and handling of this report are subject to the Terms and Conditions previously agreed to by the requestor.

**Length Diagram**

Total Line Lengths:

**Ridges = 378 ft**  
**Hips = 70 ft**

Valleys = 47 ft  
 Rakes = 469 ft  
 Eaves = 1,196 ft

Flashing = 519 ft  
 Step flashing = 435 ft  
 Parapets = 1,867 ft

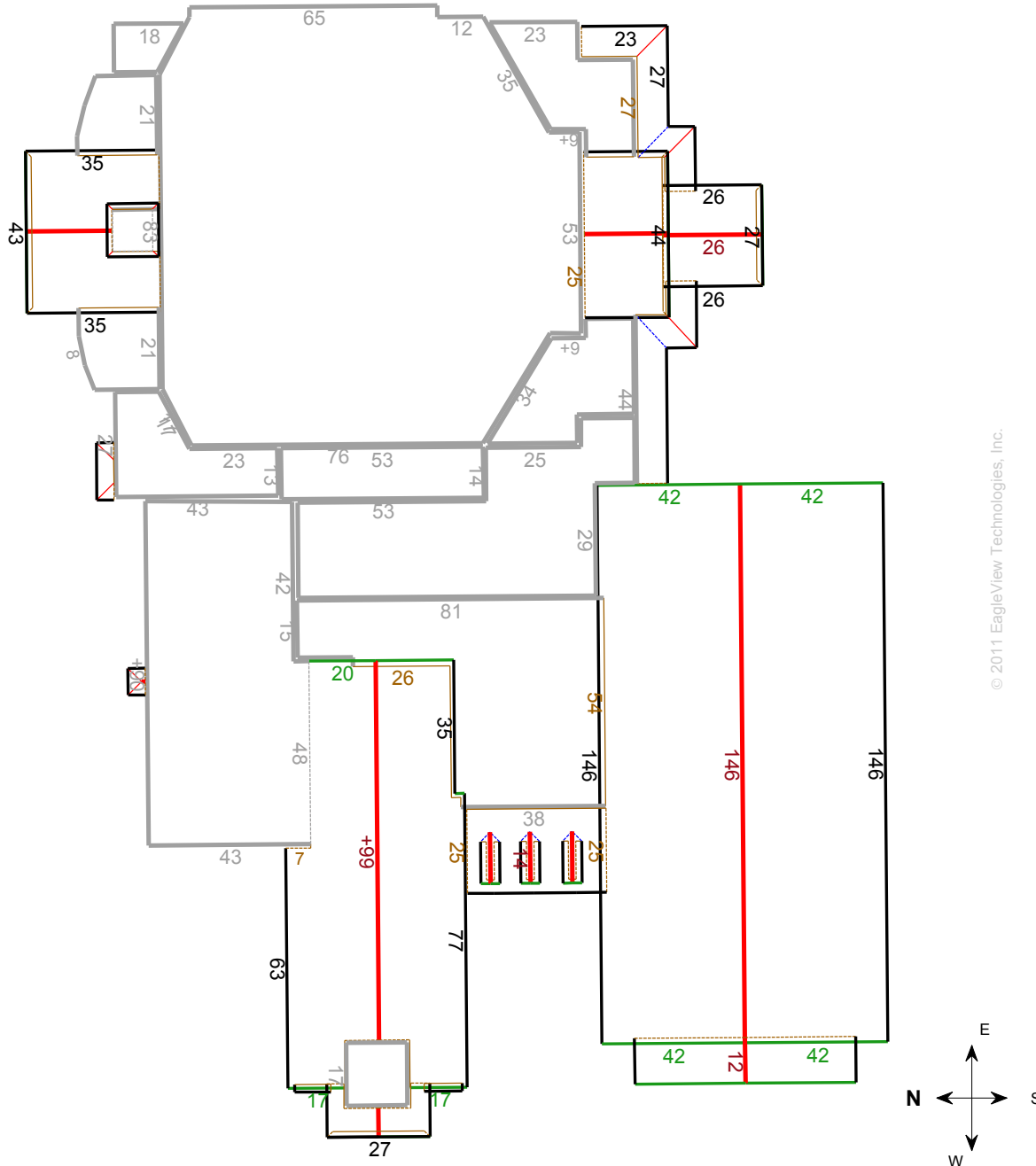

© 2011 EagleView Technologies, Inc.

**Note:** This diagram contains segment lengths (rounded to the nearest whole number) over 5 feet. In some cases, segment labels have been removed for readability. Plus signs preface some numbers to avoid confusion when rotated (e.g. +6 and +9).



Report: 2286283

This document is provided under License by EagleView Technologies to the requestor for their Internal Use. Only subject to the terms and conditions previously agreed to by the requestor when they registered for use of EagleView Technologies Services. It remains the property of EagleView Technologies and may be reproduced and distributed only within the requestor's company. Any reproduction or distribution to anyone outside of the requestor's company without EagleView's prior written permission is strictly prohibited. All aspects and handling of this report are subject to the Terms and Conditions previously agreed to by the requestor.

**Pitch Diagram**

Pitch values are shown in inches per foot, and arrows indicate slope direction. The predominant pitch on this roof is 0/12.

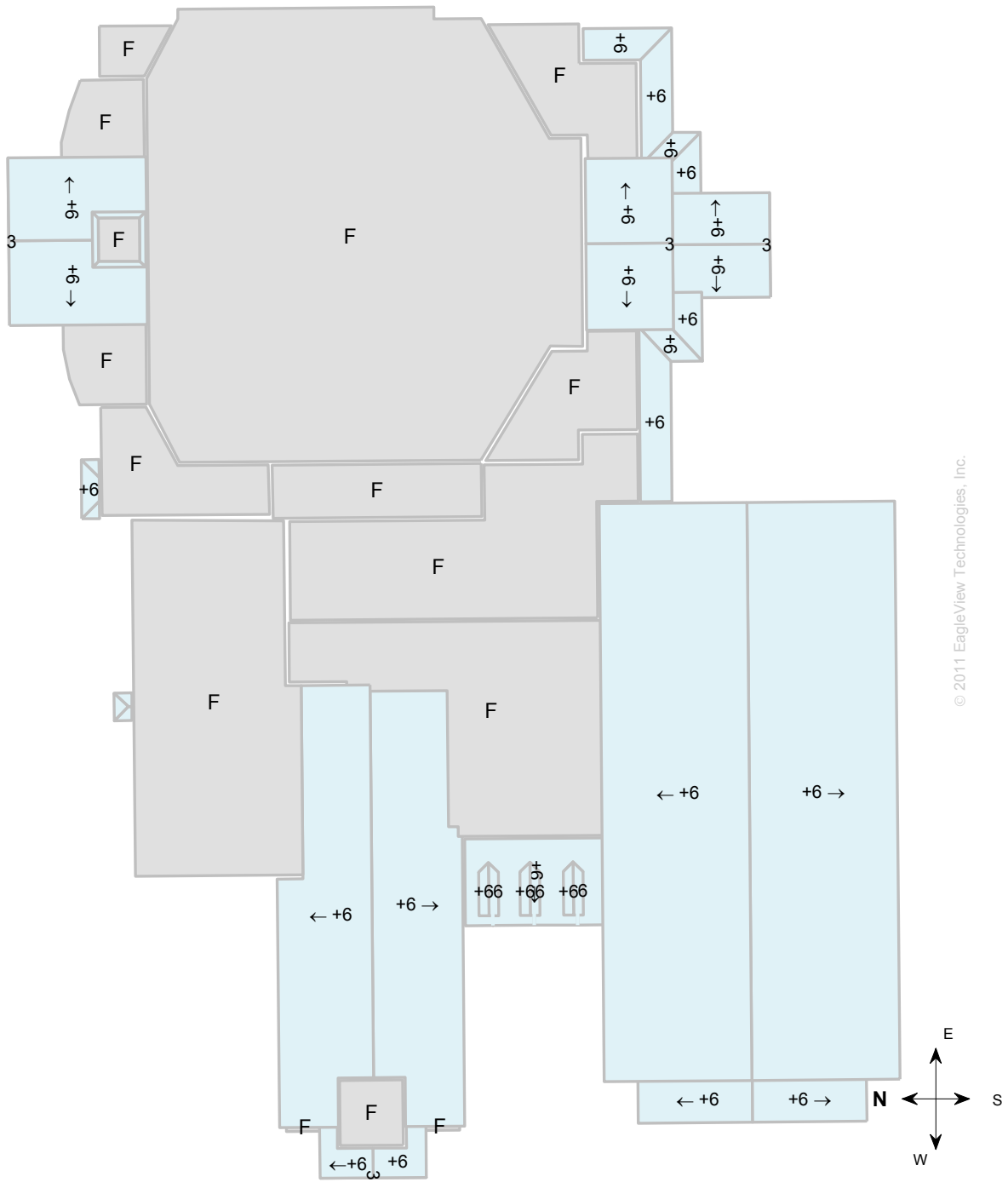

© 2011 EagleView Technologies, Inc.

Note: This diagram contains labeled pitches for facet areas larger than 20 square feet. In some cases, pitch labels have been removed for readability. Blue shading indicates a pitch of 3/12 and greater. Gray shading indicates flat, 1/12 or 2/12 pitches. If present, a value of "F" indicates a flat facet (no pitch).



Report: 2286283

This document is provided under License by EagleView Technologies to the requestor for their Internal Use Only subject to the terms and conditions previously agreed to by the requestor when they registered for use of EagleView Technologies Services. It remains the property of EagleView Technologies and may be reproduced and distributed only within the requestor's company. Any reproduction or distribution to anyone outside of the requestor's company without EagleView's prior written permission is strictly prohibited. All aspects and handling of this report are subject to the Terms and Conditions previously agreed to by the requestor.







## Report Summary

Below is a measurement summary using the values presented in this report.

### Areas per Pitch

Roof Pitches	0/12	3/12	6/12
Area (sq ft)	24939.4	206.4	24242.6
% of Roof	50.5%	0.4%	49.1%

The table above lists each pitch on this roof and the total area and percent (both rounded) of the roof with that pitch.

### Waste Calculation Table

Waste %	0%	10%	12%	15%	17%	20%	22%
Area (sq ft)	49389	54,328	55,316	56,797	57,785	59,267	60,255
Squares	493.9	543.3	553.2	568.0	577.9	592.7	602.5

This table shows the total roof area and squares (rounded up to the nearest decimal) based upon different waste percentages. The waste factor is subject to the complexity of the roof, individual roofing techniques and your experience. Please consider this when calculating appropriate waste percentages. Note that only roof area is included in these waste calculations. Ridge, hip, valley, and starter lengths may require additional material.

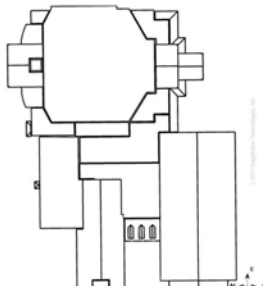

Total Roof Facets = 57

### Lengths, Areas and Pitches

Ridges = 378 ft (11 Ridges)  
 Hips = 70 ft (11 Hips)  
 Valleys = 47 ft (8 Valleys)  
 Rakes\* = 469 ft (24 Rakes)  
 Eaves/Starter\*\* = 1,196 ft (51 Eaves)  
 Drip Edge (Eaves + Rakes) = 1,665 ft (75 Lengths)  
 Parapet Walls = 1,867 (78 Lengths).  
 Flashing = 519 ft (40 Lengths)  
 Step flashing = 435 ft (41 Lengths)  
 Total Area = 49,389 sq ft  
 Predominant Pitch = 0/12

### Property Location

Longitude = -94.7976269  
 Latitude = 32.1571473

### Notes

This was ordered as a commercial property.

### Parapet Wall Area Table

Wall Height (ft)	1	2	3	4	5	6	7
Vertical Wall Area (sq ft)	1867	3734	5601	7468	9335	11202	13069

This table provides common parapet wall heights to aid you in calculating the total vertical area of these walls. Note that these values assume a 90 degree angle at the base of the wall. Allow for extra materials to cover cant strips and tapered edges.

### Online Maps

Online map of property

[http://maps.google.com/maps?f=q&source=s\\_q&hl=en&geocode=&q=410+North+Marhsall+Stree,Henderson,TX,75652-5930](http://maps.google.com/maps?f=q&source=s_q&hl=en&geocode=&q=410+North+Marhsall+Stree,Henderson,TX,75652-5930)

Directions from Tri State Roofing of Texarkana to this property

[http://maps.google.com/maps?f=d&source=s\\_d&saddr=28+Morris+Lane,+Suite+133,TEXARKANA,TX,75504&daddr=410+North+Marhsall+Stree,Henderson,TX,75652-5930](http://maps.google.com/maps?f=d&source=s_d&saddr=28+Morris+Lane,+Suite+133,TEXARKANA,TX,75504&daddr=410+North+Marhsall+Stree,Henderson,TX,75652-5930)

\* Rakes are defined as roof edges that are sloped (not level).

\*\* Eaves are defined as roof edges that are not sloped and level.



Report: 2286283

This document is provided under License by EagleView Technologies to the requestor for their Internal Use. Only subject to the terms and conditions previously agreed to by the requestor when they registered for use of EagleView Technologies Services. It remains the property of EagleView Technologies and may be reproduced and distributed only within the requestor's company. Any reproduction or distribution to anyone outside of the requestor's company without EagleView's prior written permission is strictly prohibited. All aspects and handling of this report are subject to the Terms and Conditions previously agreed to by the requestor.

### Businesses Near This Property

The links on this page point to businesses near this property (marked by a green arrow in the maps).

#### Building and Construction Service

<http://maps.google.com/maps?near=410+North+Marhsall+Stree,Henderson,TX,75652-5930&q=Building+and+Construction+Service>

#### Home Repairs

<http://maps.google.com/maps?near=410+North+Marhsall+Stree,Henderson,TX,75652-5930&q=Home+Repairs>

#### Home Improvement

<http://maps.google.com/maps?near=410+North+Marhsall+Stree,Henderson,TX,75652-5930&q=Home+Improvement>

#### Hardware and Tools

<http://maps.google.com/maps?near=410+North+Marhsall+Stree,Henderson,TX,75652-5930&q=Hardware+and+Tools>

#### Wood Materials

<http://maps.google.com/maps?near=410+North+Marhsall+Stree,Henderson,TX,75652-5930&q=Wood+Materials>

#### Restaurants

<http://maps.google.com/maps?near=410+North+Marhsall+Stree,Henderson,TX,75652-5930&q=Restauraunts>

#### Fast Food

<http://maps.google.com/maps?near=410+North+Marhsall+Stree,Henderson,TX,75652-5930&q=Fast+Food>

#### Medical Centers

<http://maps.google.com/maps?near=410+North+Marhsall+Stree,Henderson,TX,75652-5930&q=Medical+Centers>

#### Hospitals

<http://maps.google.com/maps?near=410+North+Marhsall+Stree,Henderson,TX,75652-5930&q=Hospitals>

#### Doctors

<http://maps.google.com/maps?near=410+North+Marhsall+Stree,Henderson,TX,75652-5930&q=Doctors>

#### Gas Stations

<http://maps.google.com/maps?near=410+North+Marhsall+Stree,Henderson,TX,75652-5930&q=Gas+Stations>



Report: 2286283

This document is provided under License by EagleView Technologies to the requestor for their Internal Use. Only subject to the terms and conditions previously agreed to by the requestor when they registered for use of EagleView Technologies Services. It remains the property of EagleView Technologies and may be reproduced and distributed only within the requestor's company. Any reproduction or distribution to anyone outside of the requestor's company without EagleView's prior written permission is strictly prohibited. All aspects and handling of this report are subject to the Terms and Conditions previously agreed to by the requestor.